

Strep A Rapid Test Device (CLIA Waived) (IST-502T) *Please read the instructions carefully before performing the test.*

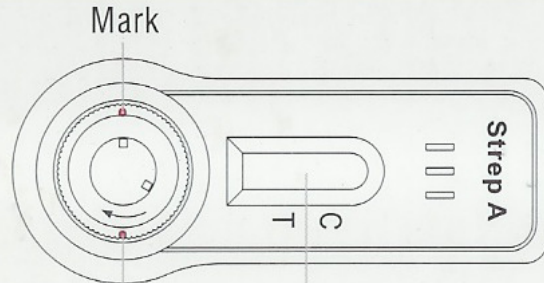

Closed Valve Position Result Window

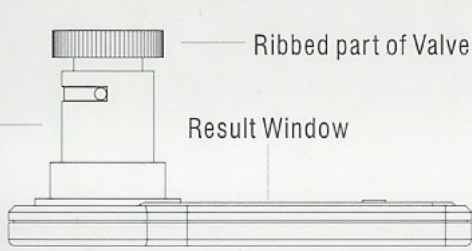
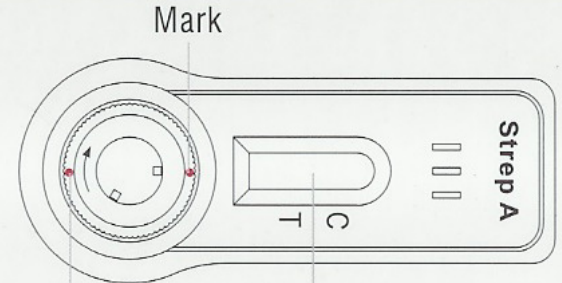

Open Valve Position Result Window

PROCEDURE Remove Test Device from the foil pouch. Place Test Device on a clean, dry, level surface. Make sure that the device is in the **Closed Valve Position**, as shown in image above.

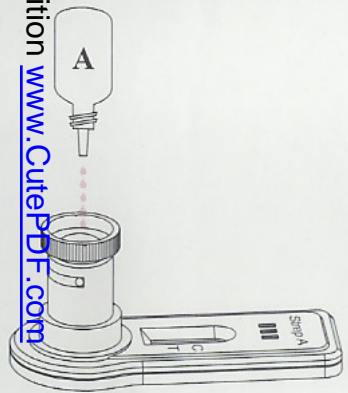

1. Holding bottles upright, add 5 drops of Reagent A, then add 5 drops of Reagent B to Chamber.

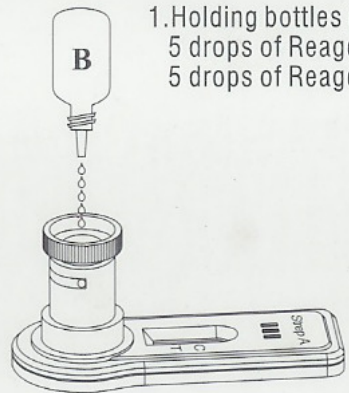

2. Add Swab to Chamber. **Agitate Swab vigorously** in the solution 10 times
• Let stand 1 minute

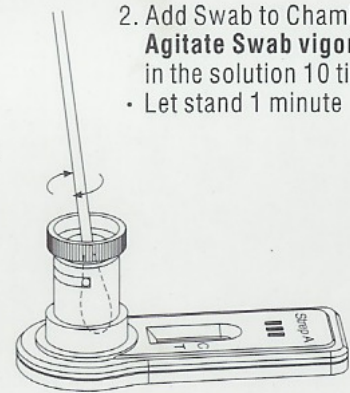

3. To Remove Swab:
• Hold down Chamber with thumb and index finger.
• Lift Swab halfway up the Chamber and press against the ribs inside the wall of the Chamber.
• Rotate Swab 5 times while pressing firmly against ribs to extract liquid.
• Discard Swab.

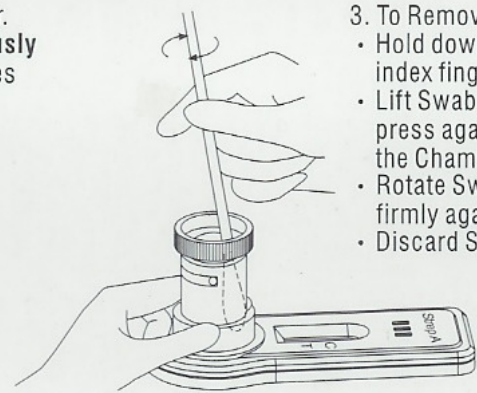

4. Hold down device on a flat surface. Open Valve by twisting ribbed part of Valve clockwise until it stops (Open Valve Position).
Begin timer. Read results at 5 minutes.

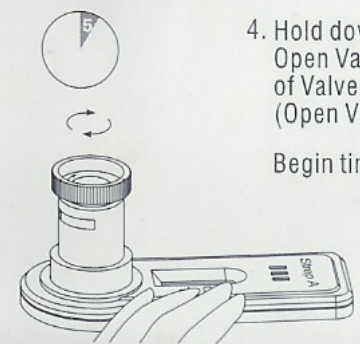

INTERPRETATION OF RESULTS

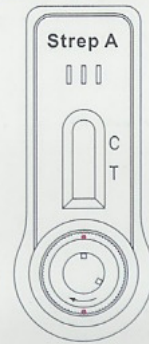

***Any shade of red in the test region (T) should be considered positive.**